

ABOUT THE DOWNHILL BRAKE SYSTEM ON THIS TRIKE

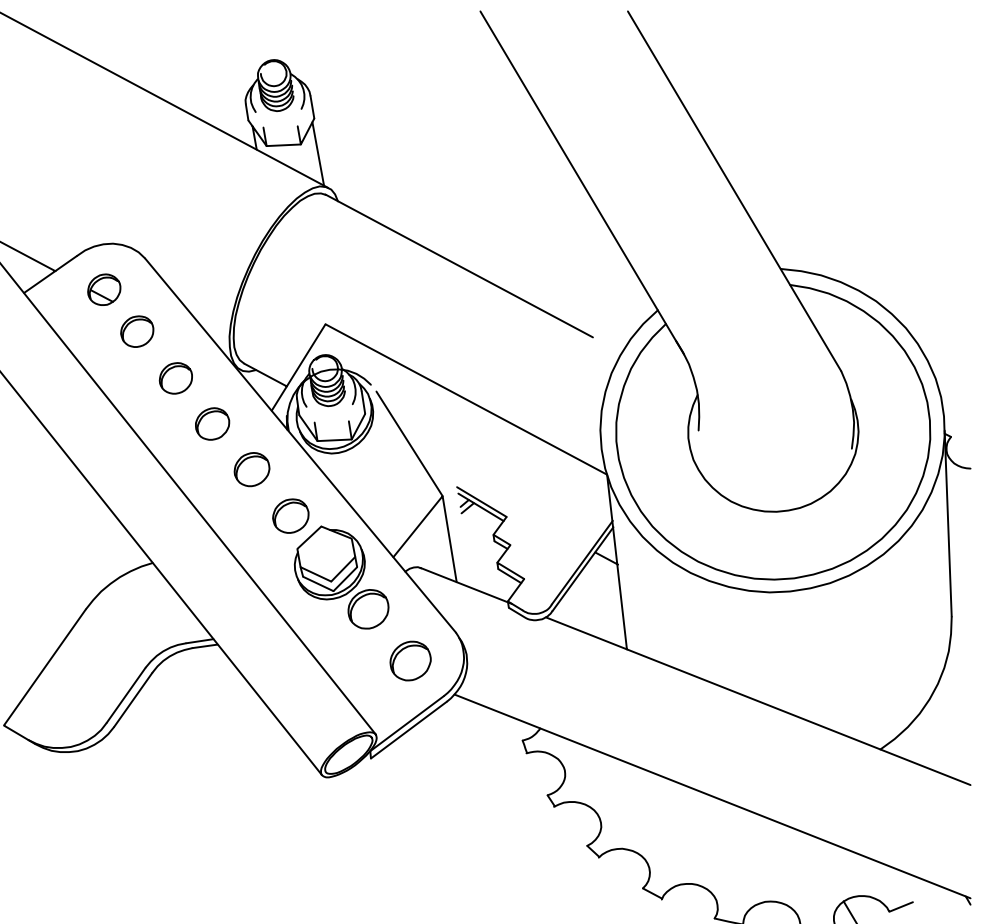

DURING NORMAL PEDALING THE STEERING & BRAKE TILLER SHOULD SIMPLY RETRACT UP AND OUT OF THE WAY WHEN NOT IN USE. NOTE HOW THE BRAKE LOCK HANGS DOWN AND OUT OF THE WAY ALSO.

THE SPRING MOUNTED BETWEEN THE BRAKE SHOE AND THE STEERING HINGE IS USED TO APPLY A CERTAIN AMOUNT OF "RETURN PRESSURE" TO BOTH THE BRAKE SHOE AND THE TILLER. IF THE SPRING IS PROPERLY ADJUSTED, AND THE NUTS ON THE BOLTS ARE JUST "SNUG", AND NOT TOO TIGHT, THE TILLER SHOULD WANT TO AUTOMATICALLY RETRACT UPWARDS WHEN NOT IN USE. IF THIS DOES NOT HAPPEN, CHECK THE NUT TIGHTNESS, AND THAT THE SPRING IS "TIGHT" ENOUGH (IN THE CORRECT HOLE ON THE STEERING HINGE).

IF THE RETURN SPRING SHOULD EVER BREAK, OR BE UNAVAILABLE, THE NUTS ON THE BOLTS CAN BE INTENTIONALLY MADE A LITTLE TIGHT TO JUST HOLD THE TILLER IN WHATEVER POSITION IT IS MOVED TO.